

- Simply hang up your garment or drapery and hold down lightly with one hand while using the clothes steamer with the other. **(Figure 4) CAUTION. Keep hands away from steam-steam can cause burns.**

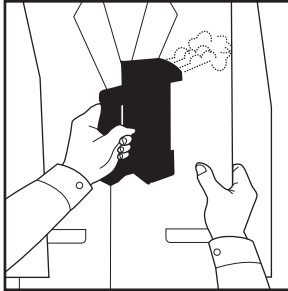

(Figure 4)

- Keeping clothes steamer in an upright position, slowly run the steam head up, down and sideways, lightly touching the fabric. (Do not use clothes steamer in a horizontal position.) To remove stubborn wrinkles, move the clothes steamer very slowly.
- If some drops of water start to eject from steam head while in use, it means the water container was overfilled; wait until the water stops ejecting before using.
- For continued use, allow the clothes steamer to cool down before refilling.

## How to Empty

- Unplug clothes steamer and allow to cool.
- Remove clothes steamer head as previously described and pour out excess water. **CAUTION: Water will be hot and can burn skin.**
- You may clean your clothes steamer by merely wiping with a damp cloth after the clothes steamer has been unplugged and allowed to cool. No other user maintenance is needed.
- Be sure clothes steamer is dry before storing or packing.

Read and follow ALL INSTRUCTIONS.

This clothes steamer **will not** scorch or burn fabrics when used as described.

### Limited Warranty

We guarantee each new Clothes Steamer against defects in materials and workmanship for a period of one year from the date of purchase. During the warranty period, we will either, at our option, repair or replace a product which proves to be defective. The above warranty shall not apply to defects resulting from: accident, unauthorized modifications, misuse, abuse, overloading, or improper maintenance. To obtain warranty service, the product must be returned to the address indicated below. Customer shall prepay all shipping charges for a product returned to us for warranty service and we shall pay for return of the product to customer. However, customer shall pay all shipping charges, duties, and taxes for a product returned to us from another country. **WE MAKE NO OTHER WARRANTIES, EITHER EXPRESSED OR IMPLIED, WITH RESPECT TO THIS PRODUCT. WE SPECIFICALLY DISCLAIM THE IMPLIED WARRANTIES OF MERCHANTABILITY AND FITNESS FOR A PARTICULAR PURPOSE.** We shall not be responsible for any other loss or damage that may arise through the use by a purchaser or others of this device and the purchaser assumes and will hold us harmless in respect to such loss. This warranty gives you specific legal rights, and you may also have other rights which vary from state to state. **Important: This is a factory-direct warranty. Do not return defective products to your retailer. All defective products must be returned to the factory. For questions or further information please call our toll free number: (800) 247-6900.**

Voltage Valet Division, Hybrinetics, Inc.  
225 Sutton Place, Santa Rosa, CA 95407  
www.voltagevalet.com

©2009 HYBRINETICS, INC.

# VOLTAGE VALET™ Clothes Steamer

Dual Voltage For Foreign and Domestic Use



Model CS2



## Instruction Manual

Read instructions before using this appliance

## Voltage Valet Dual Voltage (120/240 VAC) Clothes Steamer for Worldwide Use

### IMPORTANT OPERATING INSTRUCTIONS READ CAREFULLY BEFORE USING

## IMPORTANT SAFEGUARDS

- Read all instructions.
- Use clothes steamer for its intended use.
- To protect against a risk of electric shock, do not immerse the clothes steamer in water or other liquids or use where it can fall or be pulled into a tub, sink, or toilet.
- Never yank cord to disconnect from outlet; instead, grasp plug and pull to disconnect.
- Do not allow cord to touch hot surfaces. Empty clothes steamer and allow to cool completely before storing. Loop cord loosely around clothes steamer when storing.
- Always disconnect clothes steamer from electrical outlet when filling with water or emptying and when not in use.
- Do not operate the clothes steamer with a damaged cord or if the clothes steamer has been dropped or damaged. To avoid risk of electric shock, do not attempt to disassemble the clothes steamer. No user-servicable parts are contained inside.

- Close supervision is necessary for any appliance being used by or near children or invalids. Do not leave unattended when connected to electrical outlet.
- Burns can occur from contact with steam. Always test clothes steamer before each use by holding it away from body and directing steam away from yourself.
- Do not use outdoors or operate in the presence of explosive and/or flammable fumes.
- While emitting steam, this clothes steamer may cause burns if it is used too close to the skin, scalp or eyes; or if it is used incorrectly.
- This appliance is intended for household and travel use only; it is not intended for commercial or industrial use.
- This clothes steamer is intended for use with alternating current (A.C.). Never plug clothes steamer into a direct current (D.C.) outlet.
- Never tip clothes steamer downward when in use. Hot water may be emitted through steam vents.
- Do not** steam clothes while wearing them.

## SPECIAL INSTRUCTIONS

- To avoid a circuit overload, do not operate another high wattage appliance such as a hair dryer, etc., at the same time on the same circuit.
- If an extension cord is absolutely necessary, a 10-ampere cord should be used. Cords rated for less amperage may overheat. Care should be taken to arrange the cord so that it can not be pulled or tripped over.

## Check Voltage Before Using

- Your clothes steamer is provided with a dual voltage selector switch that is located on the underside of the clothes steamer base. This switch is set at the factory to operate at 120 volts. Refer to "Operating Instructions" section of this manual for conversion to 240 volts. **(Figure 1)**

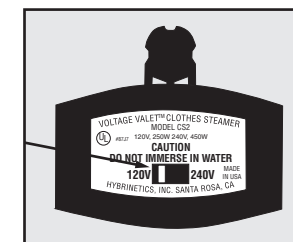

Figure 1 Bottom of Clothes Steamer

- CAUTION** - Be sure dual voltage selector switch is in correct voltage position before operating. Clothes steamer can be damaged if switch is in 120 volt position and clothes steamer is plugged into 240 volt electrical outlet. Before plugging in, read the information about dual voltage operation in the "Operating Instructions" section of this manual.

## SAVE THESE INSTRUCTIONS

### Operating Instructions

- Be sure clothes steamer is unplugged.
- Set dual voltage selector switch. For use in the U.S.A., the voltage selector switch should be placed in the 120 volt position. For use in most foreign countries, the selector switch must be placed in the 240 volt position. Confirm the voltage available at each location before using the clothes steamer. **Note:** For connection to a 240 volt supply an adaptor plug may be needed.
- Unfold handle into locked position. **(Figure 2)**

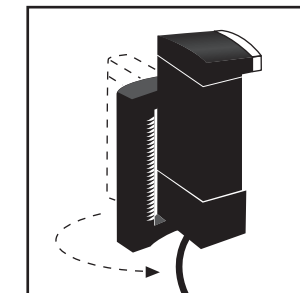

Figure 2

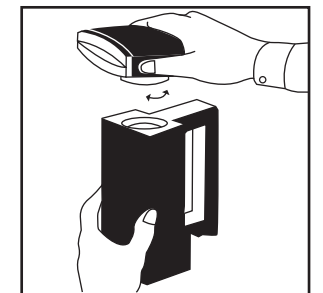

Figure 3

- To fill clothes steamer, twist clothes steamer head counterclockwise and lift to remove. **(Figure 3)**
- Fill to top of heating element (approx. 4 oz. water). **Do not overfill.**
- Replace clothes steamer head on steamer body and twist clockwise until locked into place.
- When using clothes steamer for the first time it is recommended that the clothes steamer be allowed to operate for approximately 5 minutes, unplug it, allow to cool, empty container and refill before actually using on clothes or drapery.
- Place clothes steamer on a flat surface in an upright position and plug into electrical outlet. **Never plug in the clothes steamer before filling with water.**
- Within a few minutes the clothes steamer will begin to eject a gentle flow of steam from the steam vents. The clothes steamer is now ready for use.